

NOTICE: NEW MEETING DATE
Meeting planned for 3/27/17 has been re-scheduled to 4/4/17

**Nine Mile Corner
Planned Development Rezoning Application**

NEIGHBORHOOD MEETING

You are invited to attend a meeting to discuss a Planned Development Rezoning Application that would permit Commercial/Retail and Multi-Family development on an approximately 47-acre property located at the southeast corner of Highway 287 and Arapahoe Road within the Town of Erie. The purpose of the meeting is to solicit feedback from adjacent property owners. The applicant will attend this meeting to present information, answer questions from interested parties, and to listen to concerns.

If you are unable to attend this meeting, but want to ensure your voice is heard, please contact Angie Grendahl, at Agrendahl@evgre.com or 602.567.7144. Alternatively, go to www.ninemilecorner.com to submit feedback and sign up for project updates.

DATE: Tuesday, April 4, 2017

TIME: 7:00 p.m.

PLACE: Erie Community Center
Briggs/Mitchell Multi-Purpose Room
450 Powers Street
Erie, CO 80516

Project Location Map
(property Legal Description on reverse)

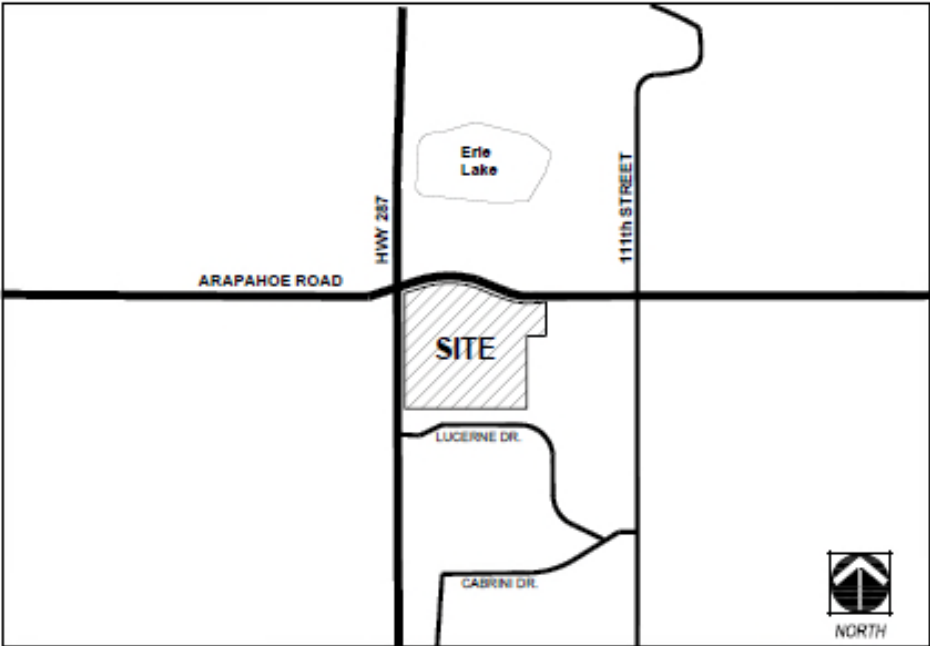

NOT TO SCALE

LEGAL DESCRIPTION (PER TITLE COMMITMENT)

PARCEL A:

PART OF THE NORTH HALF NORTHEAST QUARTER OF SECTION 34, TOWNSHIP 1 NORTH, RANGE 69 WEST OF THE 6TH PRINCIPAL MERIDIAN, DESCRIBED AS FOLLOWS:

BEGINNING AT THE SOUTHWEST CORNER OF THE NORTH HALF NORTHEAST QUARTER FROM WHENCE THE NORTHWEST CORNER OF SAID NORTH HALF NORTHEAST QUARTER BEARS NORTH 00°04'00" EAST; THENCE SOUTH 89°48'30" EAST ALONG THE SOUTH LINE OF SAID NORTH HALF NORTHEAST QUARTER, A DISTANCE OF 1434.83 FEET; THENCE NORTH 00°14'20" EAST, 845.98 FEET TO THE SOUTH LINE OF THAT PROPERTY CONVEYED BY FLOYD E. HARRIS AND NEVADIA HARRIS TO LEONARD L. LANHAM AND NINA E. LANHAM, RECORDED MAY 15, 1968 ON FILM 635 AT RECEPTION NO. 879012; THENCE NORTH 89°41'50" WEST ALONG SAID SOUTH LINE, A DISTANCE OF 366.57 FEET TO A POINT ON THE EAST LINE OF THAT PROPERTY CONVEYED BY DEED FROM FLOYD EUGENE HARRIS AND NEVADIA HARRIS TO THE TOWN OF ERIE, A MUNICIPAL CORPORATION, RECORDED APRIL 29, 1968 IN FILM 633 AT RECEPTION NO. 877395; THENCE SOUTH 00°58'00" WEST ALONG SAID EAST LINE, 31.12 FEET TO THE CENTERLINE OF THE SOUTH BOULDER CANYON IRRIGATION DITCH; THENCE TRAVERSING ALONG THE CENTERLINE OF SAID DITCH AND THE SOUTH LINE OF PROPERTY DESCRIBED ON FILM 633 AT RECEPTION NO. 877395, THE FOLLOWING COURSES AND DISTANCES: SOUTH 71°36'00" WEST 508.65 FEET; THENCE SOUTH 73°48'00" WEST, 241.52 FEET; THENCE NORTH 89°40'00" WEST, 140.82 FEET; THENCE NORTH 77°42'00" WEST, 114.23 FEET; THENCE NORTH 62°24'00" WEST, 118.52 FEET TO A POINT ON THE WEST LINE OF THE NORTH HALF NORTHEAST QUARTER OF SAID SECTION 34; SAID POINT BEING ALSO THE SOUTHWEST CORNER OF THAT PROPERTY DESCRIBED ON FILM 633 AT RECEPTION NO. 877395; THENCE SOUTH 00°04'00" WEST ALONG SAID WEST LINE OF THE NORTH HALF NORTHEAST QUARTER, A DISTANCE OF 675.12 FEET TO THE TRUE POINT OF BEGINNING,

EXCEPTING THEREFROM THAT PORTION DESCRIBED IN DEED RECORDED APRIL 15, 1983 AT RECEPTION NO. 543786, AND IN DEED RECORDED FEBRUARY 20, 1997 ON FILM NO. 2187 AT RECEPTION NO. 1678309, COUNTY OF BOULDER, STATE OF COLORADO.

PARCEL B:

A PORTION OF THE NORTH 1/2 OF THE NORTHEAST 1/4 OF SECTION 34, TOWNSHIP 1 NORTH, RANGE 69 WEST OF THE 6TH PRINCIPAL MERIDIAN, DESCRIBED AS FOLLOWS:

BEGINNING AT A POINT ON THE NORTH LINE OF SAID NORTHEAST 1/4, 20 FEET WEST OF THE NORTHEAST CORNER OF THE NORTHWEST 1/4 OF THE NORTHEAST 1/4; THENCE NORTH 89°41'50" WEST ALONG SAID NORTH LINE, 230.64 FEET; THENCE SOUTH 00°58' WEST, 469.96 FEET; THENCE SOUTH 89°41'50" EAST, 618.52; THENCE NORTH 00°14'20" EAST, 469.93 FEET TO THE NORTH LINE OF SAID NORTHEAST 1/4; THENCE NORTH 89°41'50" WEST, ALONG SAID NORTH LINE TO THE TRUE POINT OF BEGINNING; EXCEPTING THEREFROM THAT PORTION CONVEYED TO THE COUNTY OF BOULDER BY THE DEED RECORDED NOVEMBER 29, 1913 IN BOOK 381 AT PAGE 127,

COUNTY OF BOULDER, STATE OF COLORADO.

PARCEL C:

PARCEL I:

A PART OF THE NORTHWEST 1/4 OF THE NORTHEAST 1/4 OF SECTION 34, TOWNSHIP 1 NORTH, RANGE 69 WEST OF THE 6TH PRINCIPAL MERIDIAN, COUNTY OF BOULDER, STATE OF COLORADO, MORE PARTICULARLY DESCRIBED AS FOLLOWS:

BEGINNING AT THE NORTH 1/4 CORNER OF SAID SECTION; THENCE SOUTH 0°09' WEST 642.7 FEET; THENCE SOUTH 69° 45' EAST 211.4 FEET; THENCE NORTH 85° EAST 195 FEET; THENCE NORTH 71°53' EAST 718 FEET; THENCE NORTH 24°20' EAST 539 FEET TO A POINT ON THE NORTH LINE OF SAID SECTION, 20 FEET WEST OF THE NORTHEAST CORNER OF SAID NORTHWEST 1/4 OF THE NORTHEAST 1/4; THENCE WEST ALONG SAID NORTH LINE OF SAID SECTION TO THE PLACE OF BEGINNING;

EXCEPTING THEREFROM THAT PORTION CONVEYED TO THE COUNTY OF BOULDER BY THE DEED RECORDED NOVEMBER 29, 1913 IN BOOK 381 AT PAGE 127; AND EXCEPT THAT PORTION DESCRIBED IN DEED RECORDED APRIL 29, 1968 UNDER RECEPTION NO. 877396; AND EXCEPT THAT PORTION CONVEYED TO THE STATE DEPARTMENT OF HIGHWAYS, DIVISION OF HIGHWAYS, STATE OF COLORADO, BY THE DEED RECORDED FEBRUARY 8, 1983 UNDER RECEPTION NO. 532304. AND EXCEPT THAT PORTION CONVEYED TO THE DEPARTMENT OF TRANSPORTATION, STATE OF COLORADO BY THE DEED RECORDED JANUARY 2, 1998 UNDER RECEPTION NO. 1759789.

PARCEL II:

A PORTION OF THE NORTHWEST 1/4 OF THE NORTHEAST 1/4 OF SECTION 34, TOWNSHIP 1 NORTH, RANGE 69 WEST OF THE 6TH PRINCIPAL MERIDIAN, COUNTY OF BOULDER, STATE OF COLORADO, DESCRIBED AS FOLLOWS:

COMMENCING AT THE NORTH QUARTER CORNER OF SECTION 34, TOWNSHIP 1 NORTH, RANGE 69 WEST OF THE 6TH PRINCIPAL MERIDIAN, THENCE SOUTH 0°09' WEST, 642.7 FEET; THENCE SOUTH 69°45' EAST, 2.59 FEET TO A POINT ON THE WEST LINE OF THE NORTHEAST QUARTER OF SAID SECTION 34, THE TRUE POINT OF BEGINNING; THENCE SOUTH 69°45' EAST, 208.81 FEET; THENCE NORTH 85°0' EAST, 195.00 FEET; THENCE NORTH 71°53' EAST, 718.00 FEET; THENCE SOUTH 0°58' WEST, 31.12 FEET TO A POINT ON THE CENTERLINE OF THE SOUTH BOULDER CANYON DITCH; THENCE WESTERLY, ALONG THE SAID DITCH CENTERLINE AS FOLLOWS: SOUTH 71°36' WEST, 508.65 FEET; SOUTH 73°48' WEST, 241.52 FEET; NORTH 89°40' WEST, 140.82 FEET; NORTH 77°42' WEST, 114.23 FEET; NORTH 62°24' WEST, 118.52 FEET TO A POINT ON THE WEST LINE OF THE NORTHEAST QUARTER OF SAID SECTION 34; THENCE NORTH 0°04' WEST, ALONG THE SAID WEST LINE OF THE NORTHEAST QUARTER, 11.00 FEET TO THE TRUE POINT OF BEGINNING;

EXCEPTING THEREFROM THAT PORTION CONVEYED TO THE STATE DEPARTMENT OF HIGHWAYS DIVISION OF HIGHWAYS, STATE OF COLORADO BY DEED RECORDED FEBRUARY 8, 1983 UNDER RECEPTION NO. 532304.